

Apartment Information

Circuit Breaker / Electricity

If you do not have power, be sure all circuit breakers are switched to the “ON” position before calling Prairieland Energy. Circuit breakers are located inside your apartment, behind the entry door. To reset a circuit breaker, first switch it to the “OFF” position and then switch to the “ON” position. All power outages should be reported to University of Illinois/Prairieland Energy at 217-265-0855, not our office.

Outlets in the kitchen and bathrooms are equipped with a ground fault interrupter (GFI). If the power cannot be switched back on, press the reset button located on the outlet plate.

When moving out of your apartment, please switch all breakers to the “OFF” position before leaving for the final time. Please make sure the refrigerator and freezer doors are propped open before exiting the apartment to prevent mold growth. Prairieland Energy will not turn off your power if the breakers are on.

Directory

The directory located at the entrance allows access for non-residents. Visitors must search the directory listing for the resident they wish to visit and contact him/her via the intercom. The intercom will ring the phone number submitted for that particular resident. The resident would then press ‘9’ on the phone to buzz in the visitor. Please fill out the enclosed entry system form with a list of all residents names and their corresponding phone numbers.

Dishwasher

To ensure proper cleaning, do not overload dishwasher. Before starting, turn on the kitchen faucet until the water runs hot and then turn off the faucet. This will ensure your dishes are as clean as possible. Only use detergents specifically designed for dishwashers. Do not use dishwashing liquid for sink use, as this will cause the soap to foam up and overflow the dishwasher. ***Water heater must be set to at least 120° and no more than 150° Fahrenheit to have clean dishes***

Electronic Entrances

Along with apartment and mailbox keys, residents are given electronic fobs for entrance into the building. Extra fobs will not be issued for any reason. Replacement of a lost fob will be \$25.00.

Fireplace

Units 203, 303 and 403 have gas fireplaces. On the left side of the fireplace is an access panel. There is a standing pilot light which should always be lit. If it is not, please contact JSM. In the access panel is the on/off switch to start your fireplace, and a dial to control the height of the flame. All other switches should not be touched.

Units 232, 332 and 432 have electric fireplaces. There is a drop down access panel where the on/off switch and the flame intensity dial is located. Adjust the dial to your comfort level.

Garbage Disposals

Your apartment is equipped with a garbage disposal unit. To properly use your garbage disposal, first turn on the water, then turn on the disposal. Gradually place the soft food items into the disposal. After it sounds like everything is ground, turn off the disposal. Let the water run for several seconds after the disposal is turned off. Do not place large amounts of sticky or heavy food (such as rice or pasta) in the disposal. This could cause the unit to clog.

Never place a large amount of food in the disposal and then turn it on. This can also cause the unit to clog and can burn out the motor. Always follow the instructions above to dispose of waste food. Never place hard objects (such as bones, eggshells, nutshells, etc.) in the disposal. This could damage the unit. You must also never place grease down the disposal.

If the garbage disposal will not turn on and is not making a humming sound, you will need to reset the garbage disposal. First, press the 'reset' button found on the bottom of the unit. If it has reset, the button will be popped out. If that does not work, check to see if the circuit breaker has tripped and turned off in the electrical service panel.

Heating/Cooling Unit

You have a built-in heating/cooling unit that is controlled by the thermostat on the wall. Use the 'MODE' button to select whether you would like cool or heat. Use the 'FAN' button to select 'AUTO' to allow the fan to turn on and off as your apartment adjusts to the correct temperature. Use the arrow up and down buttons to adjust to the desired temperature in your apartment.

Hot Water

If you do not have hot water, be sure the circuit breaker for the water heater is switched to the "ON" position before submitting a maintenance request. Circuit breakers are located on the wall near the front door. To reset a circuit breaker, first switch it to the "OFF" position and then switch to the "ON" position.

Internet

You are responsible for setting up internet service. Your apartment is equipped with a cable or phone line connection. You can get whomever you like for internet service. AT&T (phone and/or internet) and Comcast (cable television and/or internet) are two we are aware of. Pavlov Media is also an internet provider for most buildings. Please direct any internet specific questions to your provider, not the JSM office.

Mailboxes

In order for you to receive uninterrupted mail delivery, be sure to list your name on the mailbox at your building. Please make sure to check your mail on a regular basis, as accumulated mail can make the mailbox difficult to open. If you are going to be unable to check your mail for more than a few days, please contact the post office to have your mail held.

JSM does not accept packages in our office for residents. All package deliveries must be sent

directly to your apartment address. For secure entry buildings, **do not prop the front doors open**. UPS and FedEx have access to entry door keys in order to deliver packages to residents.

Parking

Your apartment building has leased parking. Please contact the JSM office regarding parking for this building.

If you have reserved parking in the University lots D21/D22 or Krannert, you must pick up a parking hang tag from the JSM Management office on the parking lease start date. Parking hang tags must be displayed in vehicle as instructed on the 'Parking Hang Tag Acknowledgement and Vehicle Registration' form.

Pest Control

Your apartment will be scheduled for monthly preventative pest control service and inspection on the fourth Friday of each month. Additional problems may be handled by calling the office at 359-6108.

Phones

With the exception of the phone jack itself, we do not repair, replace or install anything connected with the phone system. Please make arrangements with a telephone company for telephone related problems.

Pictures/Posters

Please use thumbtacks or slender nails 1/16" in diameter or less designed to support pictures. Do not use tape on the walls.

Refrigerator

Refrigerators take 6 hours to reach the proper temperature degree for maintaining your food. When cleaning the refrigerator, be sure to wipe the door seals and their adjoining surfaces to keep the seals from tearing. When moving out of your apartment and turning off your power (see "Circuit Breaker" section) prop open the refrigerator and freezer doors to prevent mold growth. Refrigerators with mold must be discarded and the cost of a new refrigerator will be charged to the resident.

Shower

In order to operate the shower, turn on the faucet in the bathtub. Once the water is running, pull down the circular ring located at end of the faucet spout. This will divert the water from the faucet to the showerhead.

Sprinkler System

Your apartment is equipped with a sprinkler system to assist in extinguishing a fire in your apartment. DO NOT hang any items of any kind from the sprinkler heads. This could cause damage to the system. If the sprinkler heads leak in any way, immediately report the leak to our office.

Washer/Dryer

No liquids of any kind should be placed on top of the dryer. They could leak or spill and cause damage to the unit. To ensure proper laundry cleaning, do not overload the washer. This could possibly cause the washer to malfunction. No large or heavy items, such as rugs or comforters, should be laundered in the washer/dryer unit. Large items could cause the washer to malfunction.

Be sure to clean the lint trap after every dryer load.

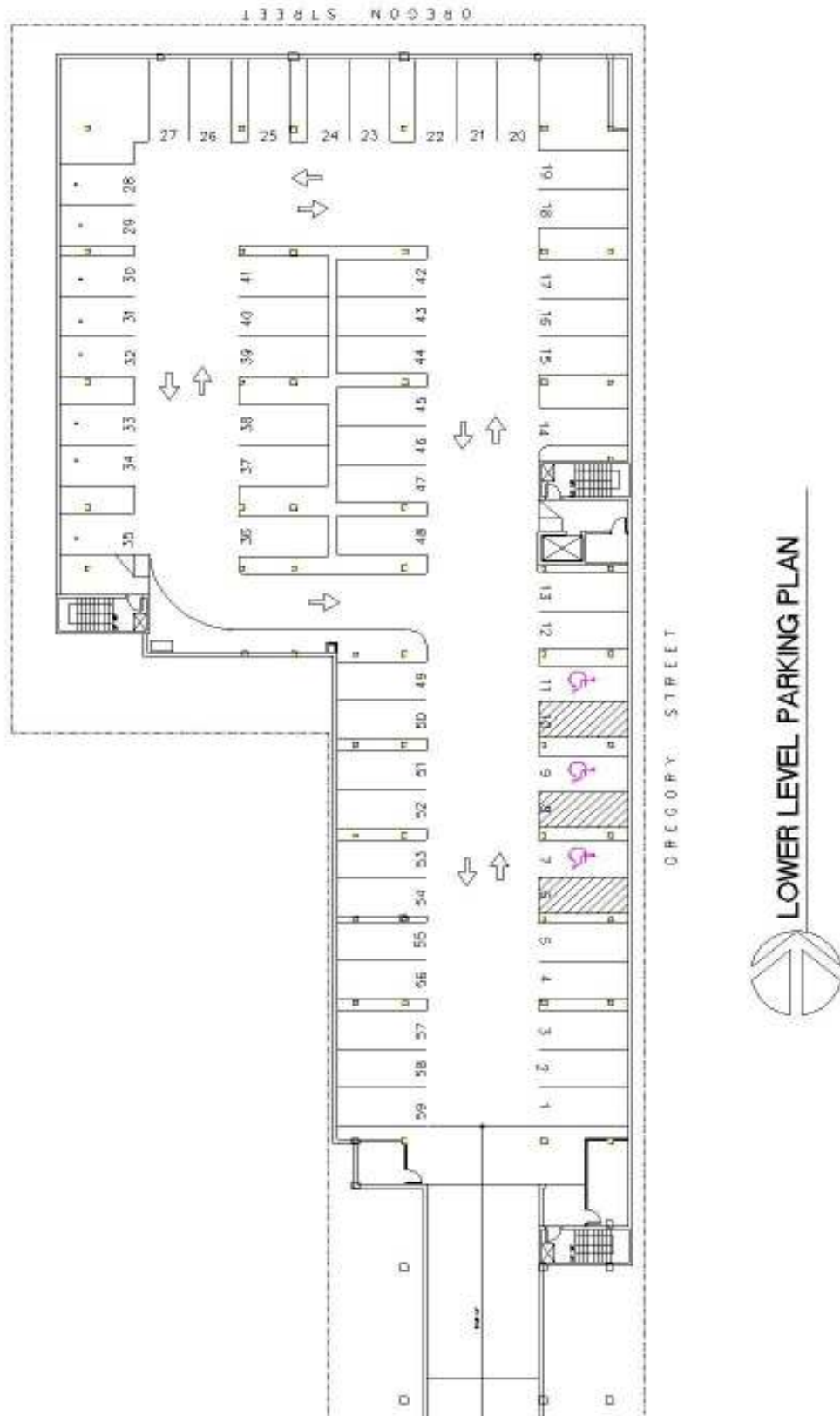

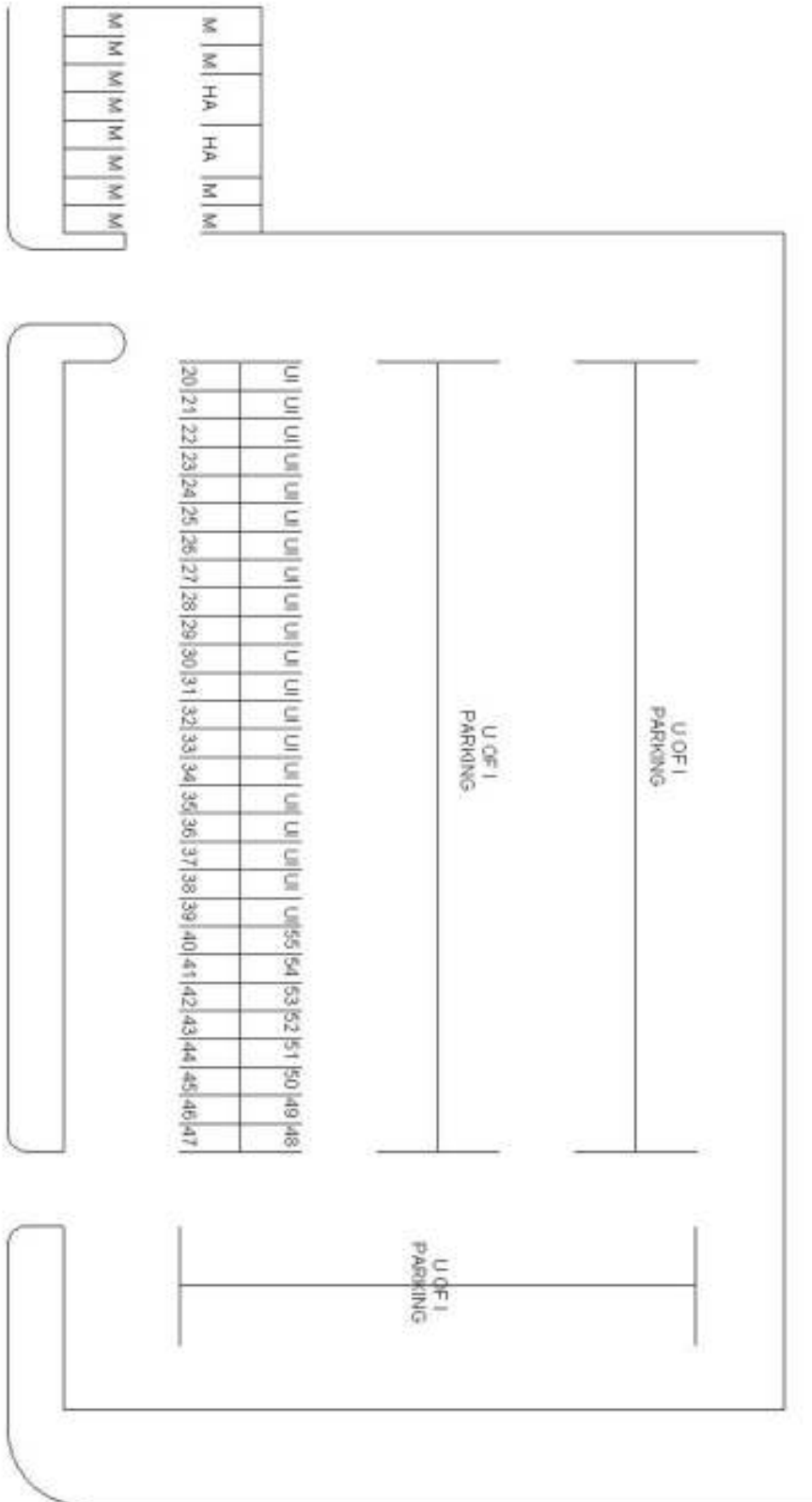

O R E G O N A V E.

LOT D22 - PARKING LAYOUT

NOT TO SCALE



M METERED SPACE
 HA HANDICAPPED ONLY PARKING
 U U OF I FACULY/STAFF ONLY



TYPICAL APARTMENT FLOOR PLAN

